

# PBCG SERIES - Deep Cycle GEL

## PBCG12-35(12V35Ah)

### Specification

Nominal Voltage	12V	
Nominal Capacity(20HR)	35.0Ah	
Dimensions	Length	195 ± 2mm
	Width	130 ± 2mm
	Container Height	164 ± 2mm
	Total Height (with Terminal)	167 ± 2mm
Approx Weight	Approx 10.5 kg	
Terminal	T6	
Container Material	ABS	
Rated Capacity	35.00 Ah/1.75A	(20hr, 1.75V/cell, 25°C)
	32.30 Ah/3.23A	(10hr, 1.75V/cell, 25°C)
	26.65 Ah/5.33A	(5hr, 1.70V/cell, 25°C)
	24.45 Ah/8.15A	(3hr, 1.70V/cell, 25°C)
	19.12Ah/19.12A	(1hr, 1.60V/cell, 25°C)
Max. Discharge Current	330A (5s)	
Internal Resistance	Approx 14.8mΩ	
Operating Temp. Range	Discharge	-20 ~ 55°C
	Charge	0 ~ 40°C
	Storage	-20 ~ 50°C
Nominal Operating Temp. Range	25 ± 3° C	
Cycle Use	Initial Charging Current less than 7.5A. Voltage	
	14.4V~15.0V at 25°C Temp. Coefficient -30mV/°C	
Standby Use	No limit on Initial Charging Current Voltage	
	13.5V~13.8V at 25°C Temp. Coefficient -20mV/°C	
Capacity affected by Temperature	40° C	103%
	25° C	100%
	0° C	86%
Self Discharge	PBCG series batteries may be stored for up to 9 months at 25° C and then a freshening charge is required.	
	For higher temperatures the time interval will be shorter.	



### Applications

- ◆ Telecommunications
- ◆ Solar system
- ◆ Wind power system
- ◆ Wheelchair
- ◆ Floor cleaning machines
- ◆ Golf trolley
- ◆ Boats

Intertek



### Constant Current Discharge (Amperes) at 25 °C (77°F)

F.V/Time	20min	30min	45min	1h	2h	3h	4h	5h	6h	8h	10h	20h
1.85V/cell	29.78	23.83	18.18	14.73	9.41	7.21	5.96	4.70	4.08	3.45	2.98	1.61
1.80V/cell	35.43	27.90	19.75	16.62	10.03	7.52	6.27	4.86	4.39	3.89	3.14	1.68
1.75V/cell	38.25	29.16	21.00	17.24	10.35	7.84	6.58	5.02	4.55	4.08	3.23	1.75
1.70V/cell	40.13	30.41	22.26	17.87	10.66	8.15	6.83	5.33	4.70	4.55	3.35	1.81
1.65V/cell	42.32	31.35	23.20	18.50	11.29	8.46	7.05	5.64	4.86	4.70	3.48	1.88
1.60V/cell	43.89	32.92	24.14	19.12	11.91	8.78	7.37	5.96	5.17	5.02	3.61	1.95

### Constant Power Discharge (Watts/cell) at 25 °C (77°F)

F.V/Time	20min	30min	45min	1h	2h	3h	4h	5h	6h	8h	10h	20h
1.85V/cell	55.10	44.08	33.64	27.26	17.40	13.34	11.02	8.70	7.54	6.38	5.51	2.98
1.80V/cell	63.77	50.22	35.55	29.91	18.06	13.54	11.29	8.75	7.90	7.00	5.64	3.02
1.75V/cell	66.93	51.02	36.76	30.17	18.10	13.72	11.52	8.78	7.96	7.13	5.65	3.05
1.70V/cell	68.22	51.70	37.84	30.38	18.12	13.86	11.62	9.06	7.99	7.73	5.70	3.08
1.65V/cell	69.83	51.73	38.28	30.52	18.62	13.97	11.64	9.31	8.02	7.76	5.74	3.10
1.60V/cell	70.22	52.67	38.62	30.60	19.06	14.04	11.79	9.53	8.28	8.03	5.77	3.11



## Dimensions

### T6 Terminal

Unit: mm

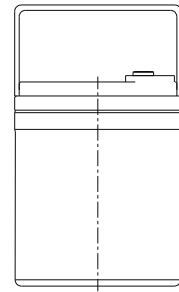
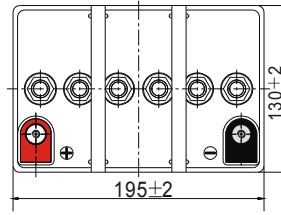
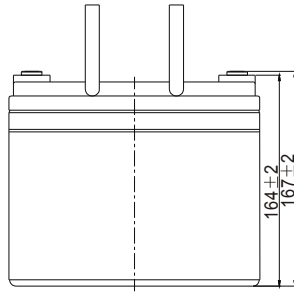
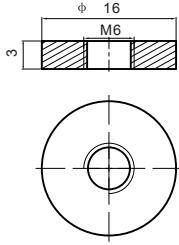

## Discharge Characteristics

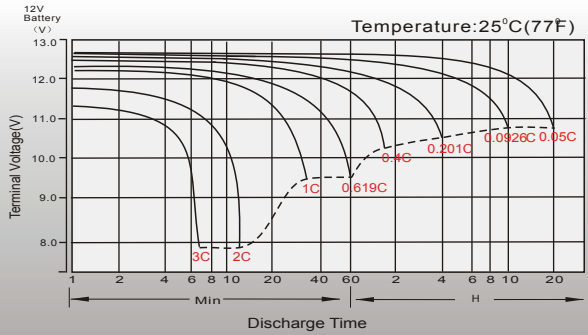

## Float Charging Characteristics

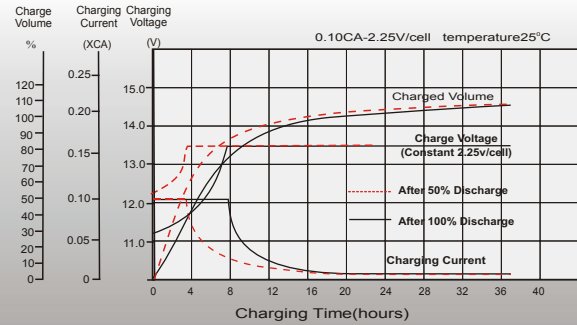

## Temperature Effects in Relation to Battery Capacity

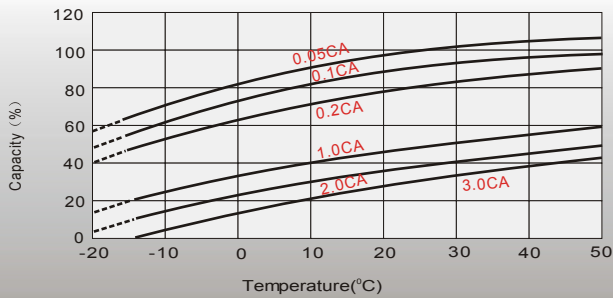

## Effect of Temperature on Long Term Float Life

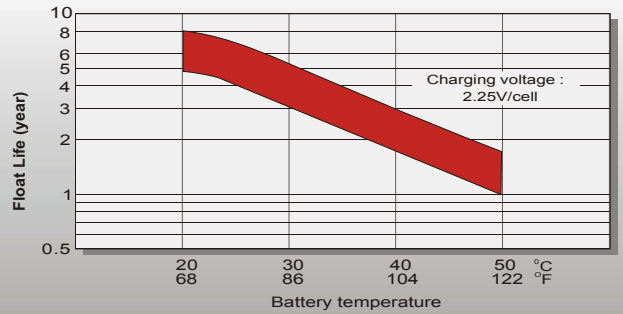

## Cycle Life in Relation to Depth of Discharge

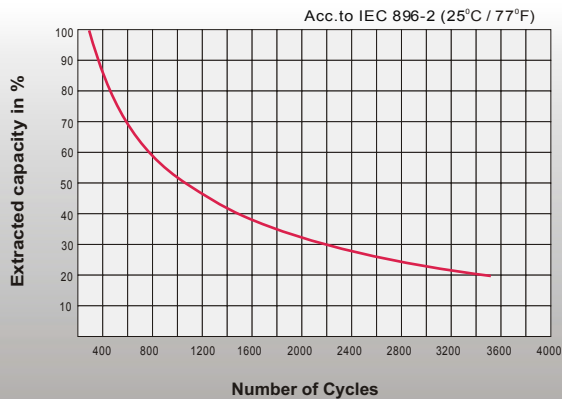

## General Relation of Capacity VS. Storage Time

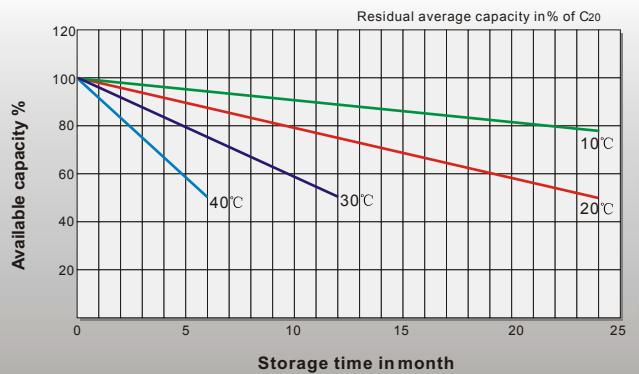

## Contact